

# STANDARD METAL

---

## INSTALLATION MANUAL

---





## TABLE OF CONTENTS

2		Introduction
2		Important Information
2		Safety
3		Before You Begin
3		Delivery & Unloading
3		Material-Handling Instructions
3		Fasteners and Accessories
4		Field Cutting
4		Touch-Up
4		Ventilation
4		Roof Care & Maintenance
5-13		Diagrams & Details

## Introduction

---

Welcome to Buckeye. At Buckeye Metal Sales, we commit to a high standard of quality and safety. We offer this guide to ensure the best outcomes for standard and Buckeye Wave panel installation. May success be yours.

## Important Information

---

This manual is designed as a guide only for installing the specific Standard and Buckeye Wave panels. We are not responsible for performance issues when metal is not installed according to the recommendations laid out in this manual. We reserve the right to modify this manual at any time. Questions you have may be directed to your representative.

Buckeye Metal Sales recommends following all your building regulations, codes for your area, and industry best practices. The contractor or installer is responsible to install metal safely.

## Safety

---

Always use appropriate care and caution when installing metal panels and accessories. Do not walk on the panels; they are not able to withstand large amounts of weight. Never stand on a panel even briefly before it is fully fastened. Your metal panels may be very slippery in certain weather conditions. It is recommended that metal installation be supervised by a professional in the field.

## Before You Begin

---

Check that all codes applying to the area of the installation are met.

Buckeye Metal Sales' panels are designed for open frame or direct installation over plywood/OSB #30 or UDL moisture barrier of equal standards. Check your building codes to see if Ice Guard is required.

Be sure an authorized professional has checked the project for problems such as rot, sagging, or any other structural issues.

Take all the necessary measurements on site before ordering to ensure order accuracy.

## Delivery & Unloading

---

Our professional drivers deliver our metal with tilt-bed trailers. On the rare occasion that additional unloading equipment is needed, we will notify you in advance. After unloading, each load should be inspected by the installer and any issues or damages reported immediately.

## Material-Handling Instructions

---

Handle painted panels and accessories with care. To avoid scratching and damage, do not drag the panels across other panels, over the ground, or over rough surfaces of any kind. To prevent buckling, carry the panels horizontally to the ground and use the appropriate amount of people to carry the panels. Do not allow panels to contact copper, lead, or uncoated steel runoff.

Handling metal panels in adverse weather conditions should always be done with the greatest caution and overseen by a professional. Buckeye recommends wearing soft-soled rubber shoes and gloves to keep panels pristine and to keep installers safe.

## Fasteners and Accessories

---

Buckeye Metal Sales recommends the forty-year ZXL screw or the standard 1/4" wood binder.

Screws are generally applied 2 feet on center or 80 screws per square for the 36" panels.

Use a screw gun that has the correct speed and ensure the torque settings are set to prevent any damage to the panel or screw.

## Field Cutting

---

We recommend using tin snips or electric cutters for cutting metal. Be sure to remove all chips and slivers that are created by the cutting. Failure to do so will result in damage to the finish of the metal and will shorten the lifespan of your metal. Wear appropriate safety gear while cutting metal.

## Touch-Up

---

If minor scratches or nicks appear during the handling of the metal, use Akzo Nobel paint provided by Buckeye Metal Sales. Do not paint the whole panel. Instead, use a small brush or Q-tip and apply only to the scratch or nick. Apply coats as needed.

## Ventilation

---

Vapor barriers and vented closures are necessary to prevent condensation under your roof. Condensation occurs when moisture-laden air comes in contact with a surface that has a temperature equal to or below the dew point of the air. This can cause several issues, all of which can be avoided with the proper ventilation products and techniques. Please talk to a Buckeye Metal Sales representative to source the proper products.

## Roof Care and Maintenance

---

Dirt pickup may cause slight discoloration of the paint when it has been exposed to a dirt-saturated atmosphere for extended periods of time. Some chalking may also occur in areas of extreme sunlight exposure.

While the factory-applied finishes are very durable and will last many years, it may eventually become necessary to clean them. A light cleaning is usually all that is needed, and with the proper cleaning products, you can easily restore the panels to their original beauty.

Simply spray the panels with plain water using a water hose or a pressure washer. In many cases, this will be sufficient.

In areas of heavier dirt deposits, a cloth or soft bristle brush and a solution of water and detergent (1/2 cup of Tide or similar laundry detergent per gallon of water) may be used, followed by a thorough rinse with clean water.

Mildew can occur in areas with high humidity but is not normally a problem due to the mildew resistance of the baked-on finish applied during manufacturing. To remove mildew, mix together the following.

- 1 cup trisodium phosphate
- 1-1½ qt. of sodium hypochlorite solution
- 1 cup laundry detergent
- 4 quarts clean water

Apply this solution to the needed area using a mop or soft-bristled brush. Rinse thoroughly after applying and repeat as necessary.

Strong solvents or abrasive cleaners should not be used. Most solvents are flammable and should be handled with care. Do not use wire brushes, abrasives, or cleaning tools that may damage the coating surface.

# Trim Detail

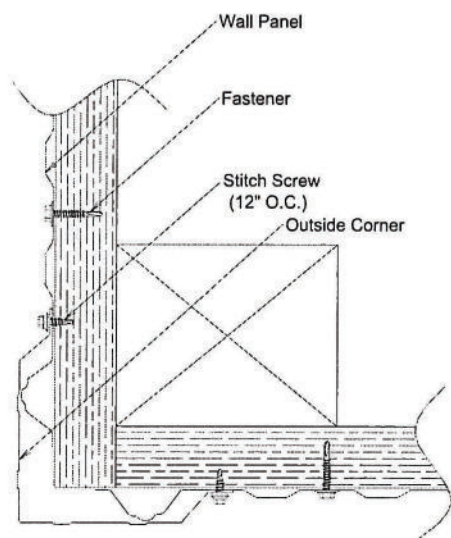

Outside Corner

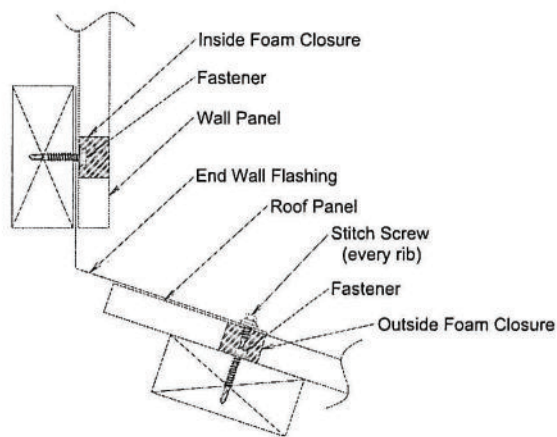

End Wall Flashing

(transition is installed the same way but on a different pitch)

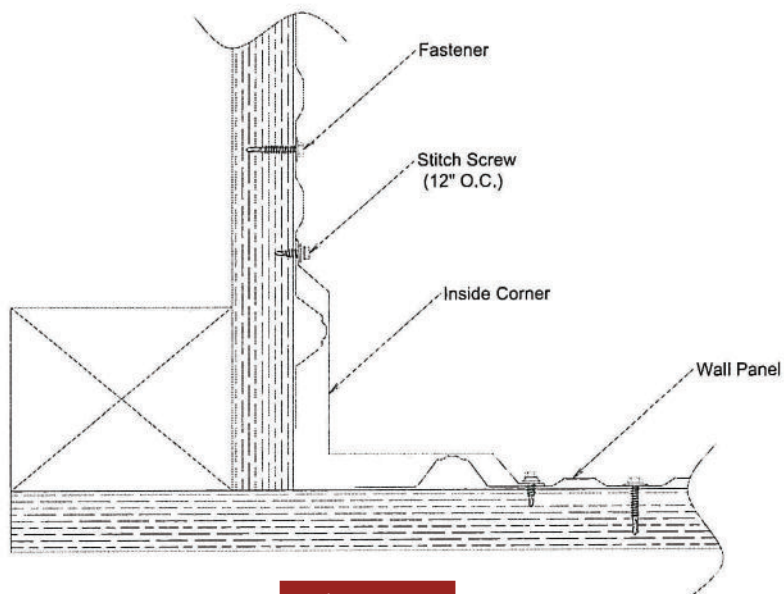

Inside Corner

## Trim Detail

---

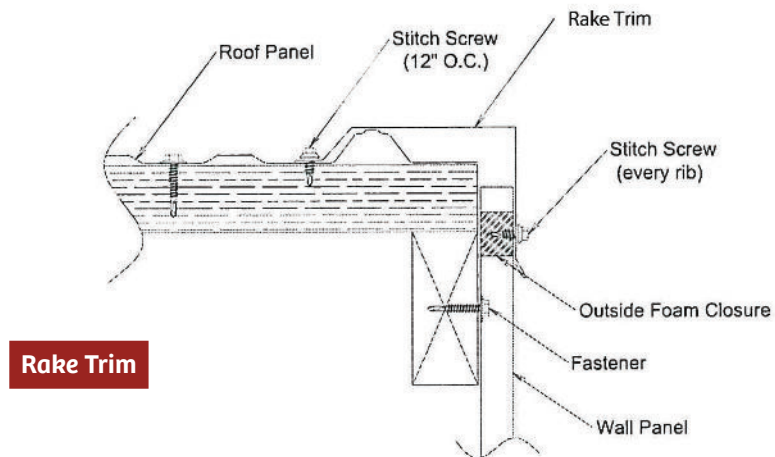

### Valley Flashing

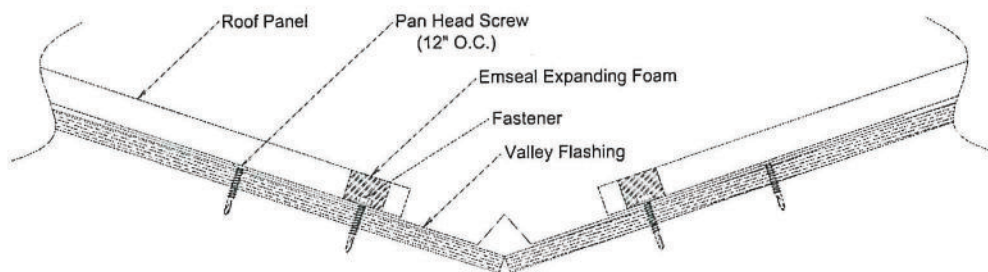



# Trim Detail

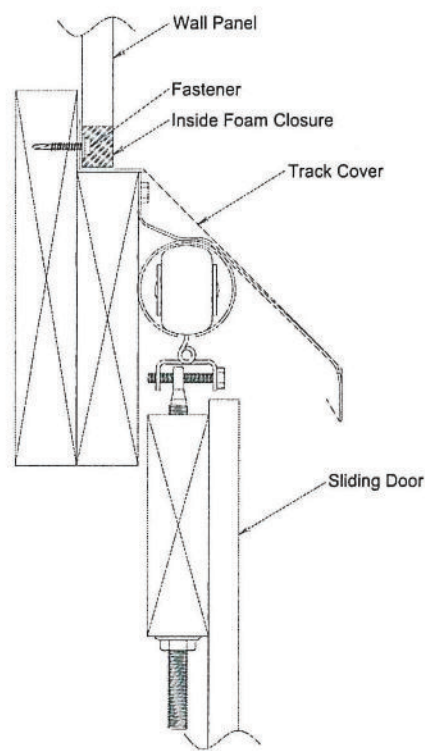

Door Track

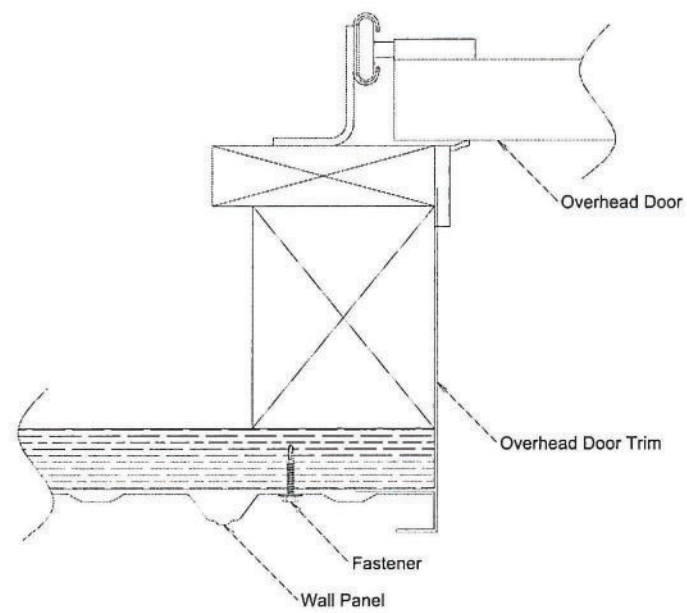

Overhead Door Trim

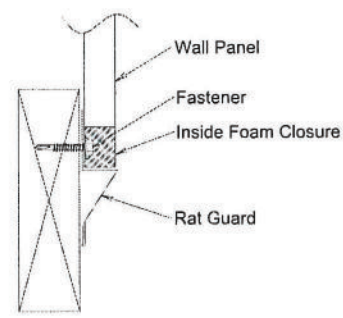

Rat Guard

## Trim Detail

---

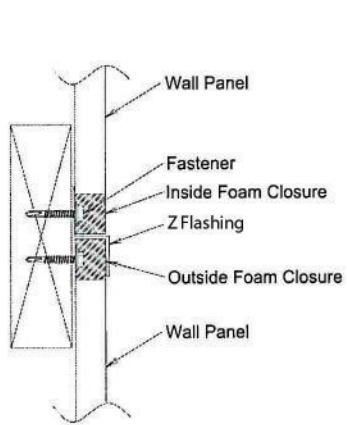

**Z Flashing**

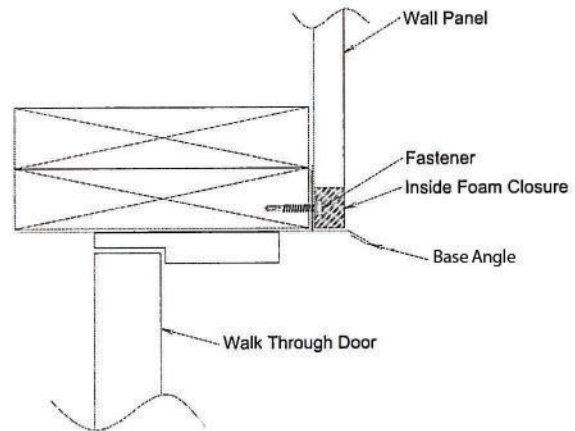

**Base Angle**

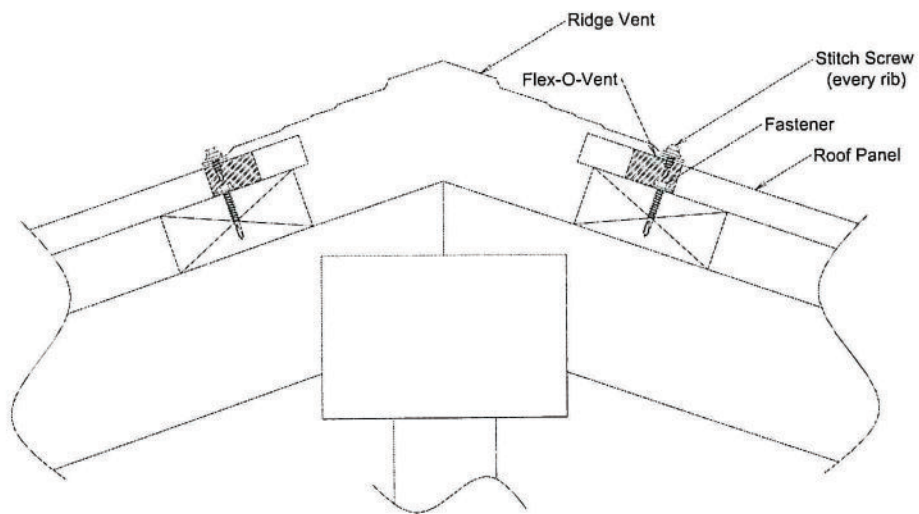

**Ridge Cap**



# Fastening Patterns



Buckeye Wave Profile



Standard 5 rib Profile



Fastening Pattern for Buckeye Wave - Field of Panel



Fastening Pattern for Buckeye Wave - End of Panel

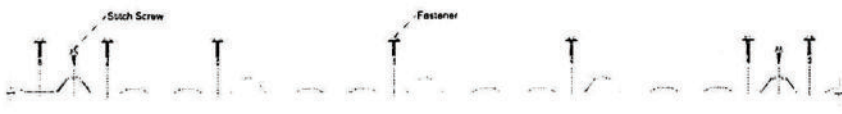

Fastening Pattern for Standard 5 rib - Field of Panel

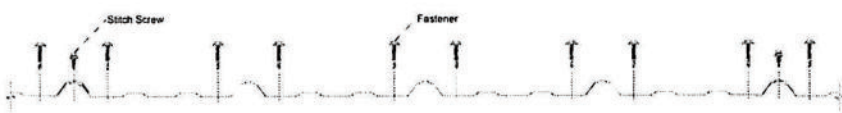

Fastening Pattern for Standard 5 rib - End of Panel

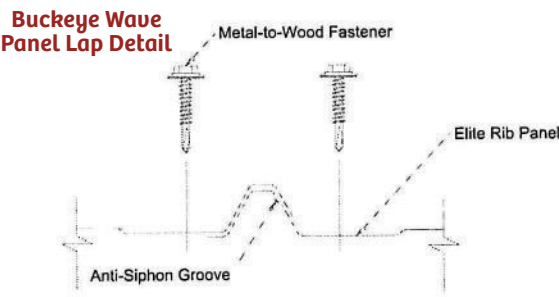
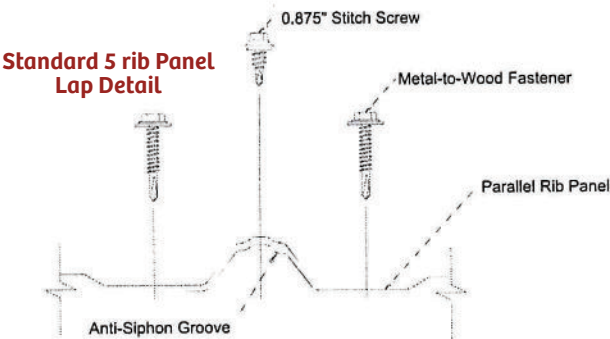

# Trim Profiles/Post Frame

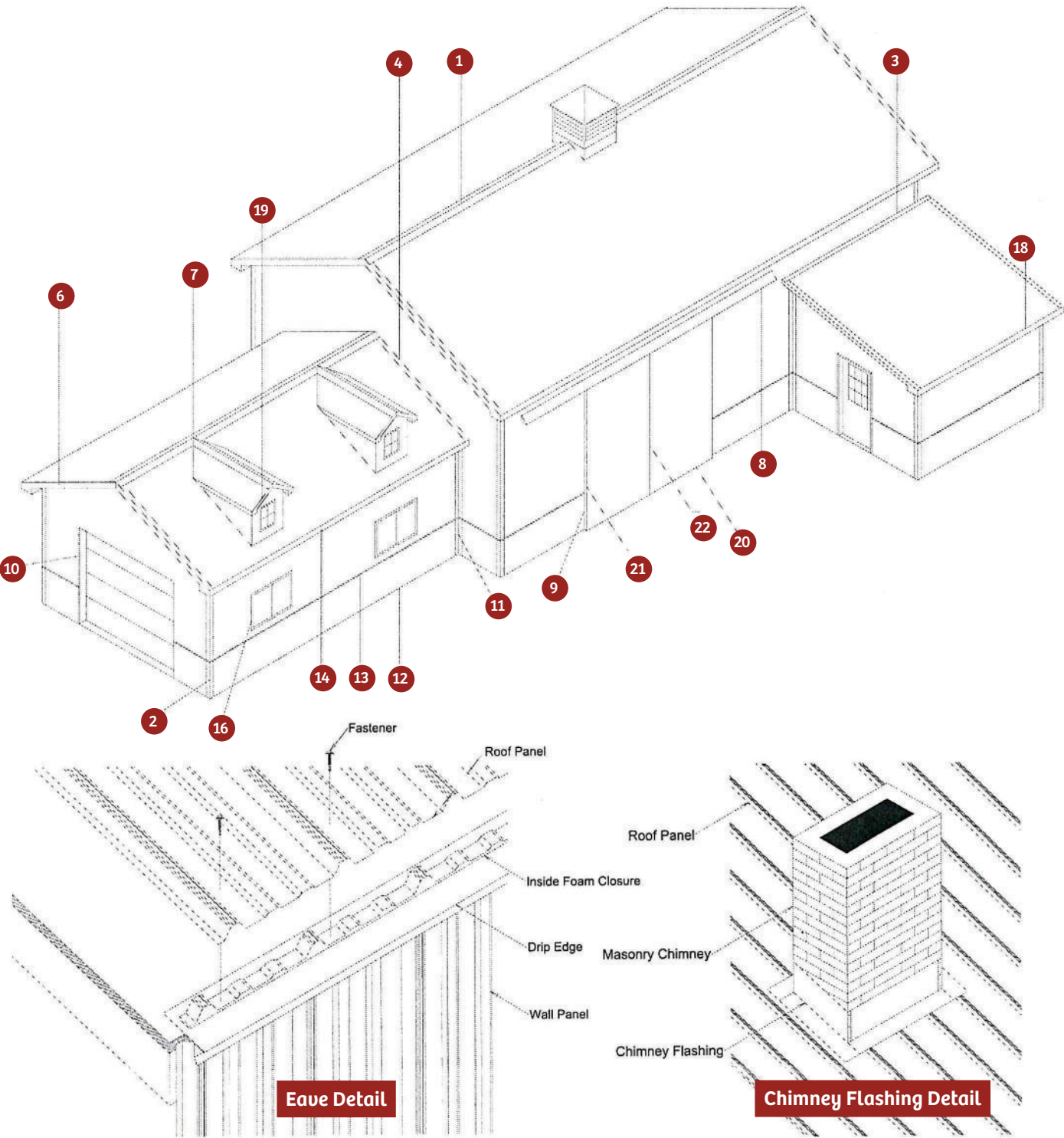

# Trim Profiles/Post Frame

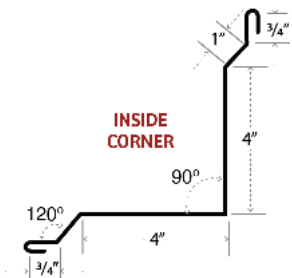
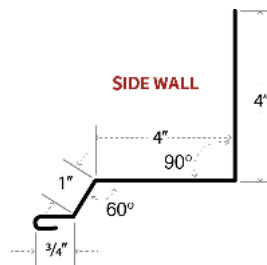
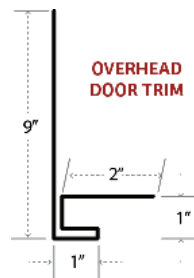
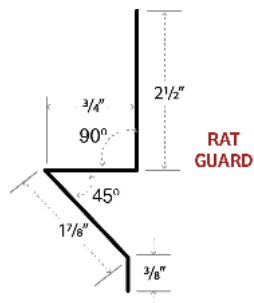
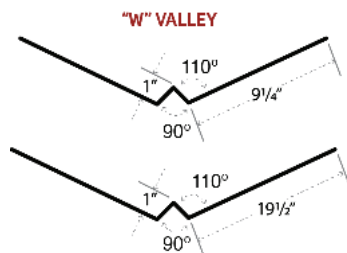
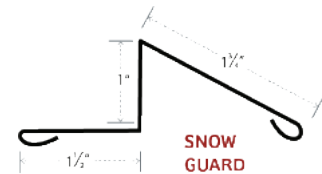
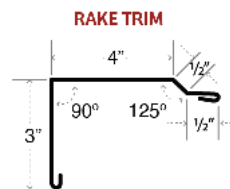
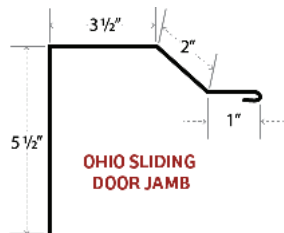
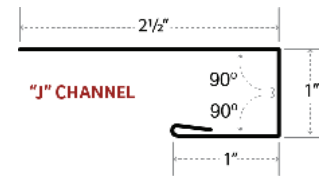
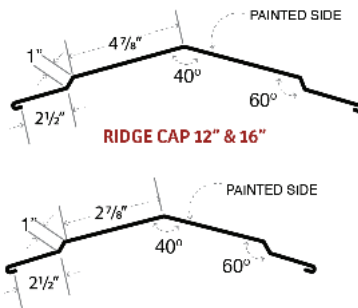
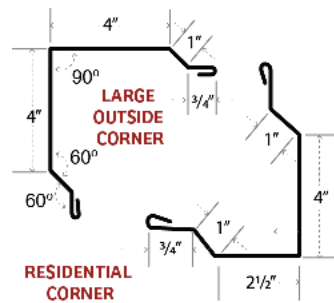
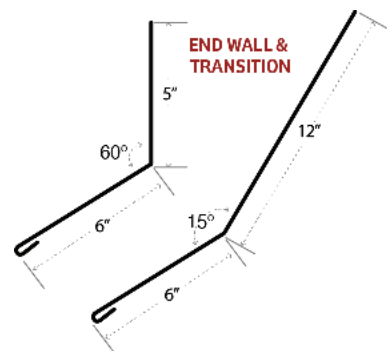
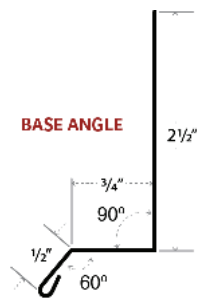
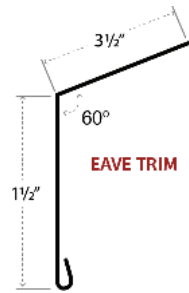





**Serving.  
Expert.  
Responsive.**

You are at the center of  
what we do here at Buckeye.



### Contact us!

PHONE: 740.998.4304  
EMAIL: [jay@buckeyemetalsales.net](mailto:jay@buckeyemetalsales.net)  
WEB: [Buckeyemetalroofing.com](http://Buckeyemetalroofing.com)

ADDRESS: 406 Jamison Road  
Frankfort, OH 45628-9044

HOURS: Monday-Friday 7:30-4:30  
Saturday by appointment